

## 38 784 000 **SKATE COSMOPOLITAN ACTUATION PLATE**



### PRODUCT DESCRIPTION

- manual activation for urinal
- set for final installation
- for Rapido U or Rapido UMB
- 116 x 144 mm
- mechanical functional cartridge
- flow pressure min 0.5 bar
- operating pressure max 6 bar
- 1.0 - 6.0 adjustable
- GROHE Long-Life finish



## 38 784 000 **SKATE COSMOPOLITAN ACTUATION PLATE**

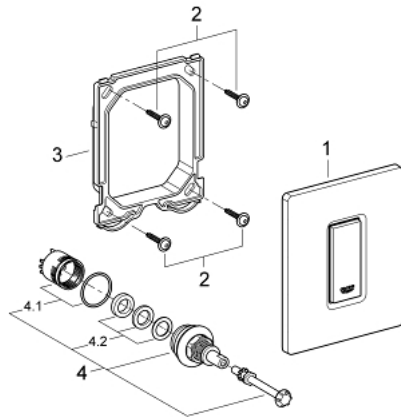

### **SPARE PARTS**

- 1: Top plate with push button (Spare part-nr. 42377000)
- 2: Screw (Spare part-nr. 6636200M)
- 3: Mounting frame (Spare part-nr. 66845000)
- 4: Cartridge (Spare part-nr. 42354000)
- 4.1: Seal kit (Spare part-nr. 4271500M)
- 4.2: Rings (Spare part-nr. 4282000M)