

32 278 001 **START SINGLE-LEVER BATH MIXER 1/2"**

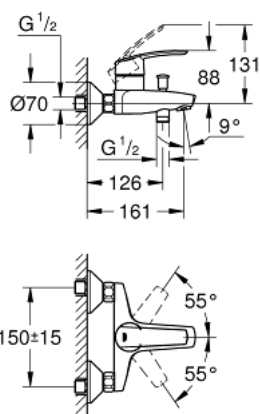

PRODUCT DESCRIPTION

- wall mounted
- GROHE SilkMove 35 mm ceramic cartridge
- with temperature limiter
- adjustable flow rate limiter
- GROHE Long-Life finish
- automatic diverter: bath/shower
- shower outlet 1/2" with integrated non-return valve
- mousseur
- S-unions
- metal wall escutcheons
- protected against backflow

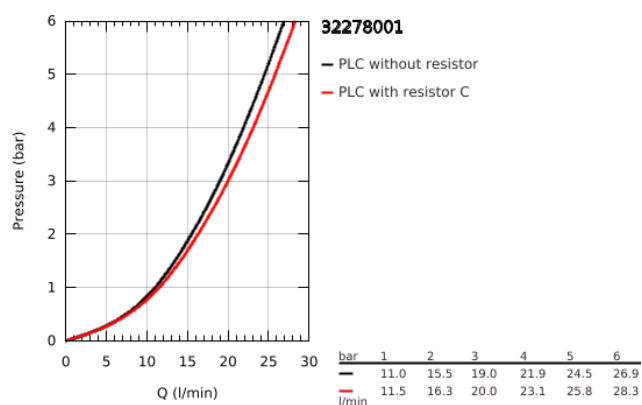

32 278 001 **START SINGLE-LEVER BATH MIXER 1/2"**



SPARE PARTS

- 1: Lever (Spare part-nr. 46898000)
 - 2: Cap (Spare part-nr. 46899000)
 - 3: Cartridge (Spare part-nr. 46374000)
 - 4: Diverter knob (Spare part-nr. 65648000)
 - 5: Diverter (Spare part-nr. 65655000)
 - 6: Non-return valve (Spare part-nr. 08565000)
 - 7: Mousseur (Spare part-nr. 13952000)
 - 8: Screw connection 1/2" (Spare part-nr. 45044000)
 - 9: S-union (Spare part-nr. 12075000)
 - 9.1: Seal (Spare part-nr. 0138600M)
 - 9.2: Escutcheon (Spare part-nr. 0221000M)
 - 10: Extension 3/4", 20 mm (Spare part-nr. 0713000M)*
 - 11: Socket Spanner (Spare part-nr. 19332000)*
 - 12: Special spanner (Spare part-nr. 19377000)*
- * Optional accessories