

31 552 SD0 K200 STAINLESS STEEL SINK WITH DRAINER

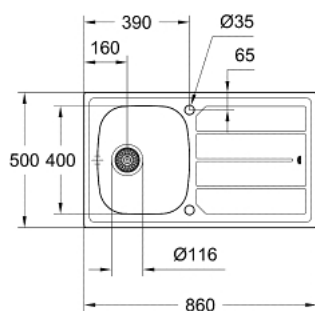

PRODUCT DESCRIPTION

- model: K200 45-S 86/50 1.0 rev
- mounting type: standard built-in
- material: stainless steel AISI 304 (V2A)
- material thickness: 0.6 mm
- GROHE Long-Life finish
- finish: pre-polished
- GROHE Whisper
- min. cabinet size: 450 mm
- dimensions: 860 x 500 mm
- 1 bowl: 340 x 400 x 170 mm
- GROHE FastFixation installation system
- sink mountable left or right
- cut-out: 840 x 480 mm
- drilling holes: 2 x 35 mm
- drainer: automatic waste fitting
- accessories included: automatic waste fitting with rotary handle, waste kit, basket strainer waste, mounting set
- amount of fasteners included (top mount): 6
- outer radius: R10, inner bowl radius: R95

31 552 SD0 **K200 STAINLESS STEEL SINK WITH DRAINER**

SPARE PARTS

1: Plug (Spare part-nr. 42576SD0)

2: Turning handle (Spare part-nr. 42575SD0)

