

29 396 DL0 **ATRIO CONCEALED VALVE EXPOSED PART**

PRODUCT DESCRIPTION

- for concealed valve 35 028 or 29 032
- GROHE Long-Life finish
- installation depth infinitely adjustable 20-80 mm
- escutcheon with screwable wall sealing
- with cross handle

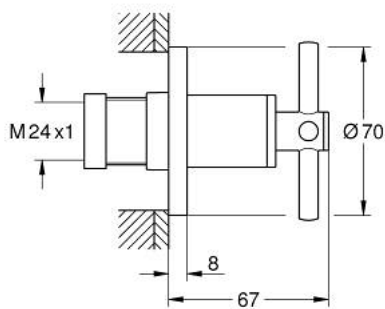

29 396 DL0 **ATRIO CONCEALED VALVE EXPOSED PART**

SPARE PARTS

1: Extension for spindle (Spare part-nr. 45988000)

2: Cross handles (Spare part-nr. 14215DL0)

