

29 147 000 SMARTCONTROL CONCEALED MIXER WITH ONE VALVE

PRODUCT DESCRIPTION

- final installation for
- GROHE Rapido SmartBox (35 604)
- GROHE FastFixation metal wall escutcheon, retroactively 6° adjustable
- GROHE Long-Life finish
- GROHE SmartControl push for ON-OFF, turn for volume adjustment from GROHE Water Saving to Full Flow
- exchangeable symbols
- cartridge for temperature mixing
- outlet B = 27 l/min, outlet C = 27 l/min

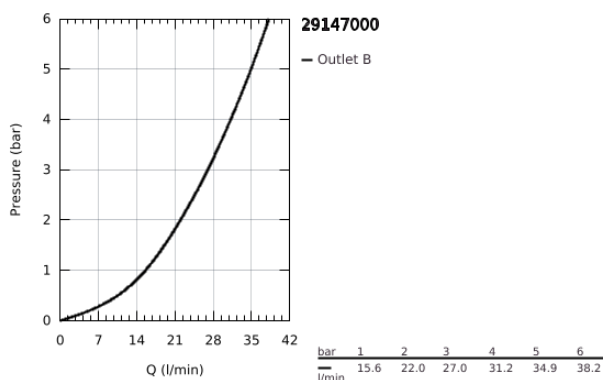

29 147 000 SMARTCONTROL CONCEALED MIXER WITH ONE VALVE

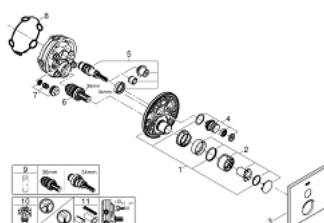

SPARE PARTS

- 1: Mounting plate (Spare part-nr. 48362000)
- 2: Handle (Spare part-nr. 46990000)
- 3: Escutcheon (Spare part-nr. 46994000)
- 4: Push button (Spare part-nr. 48361000)
- 4.1: pushbutton (Spare part-nr. 14077000)
- 5: Cartridge (Spare part-nr. 48359000)
- 5.1: Spindle (Spare part-nr. 49088000)
- 6: Cartridge (Spare part-nr. 46989000)
- 7: Non-return valve (Spare part-nr. 49085000)
- 8: Seal (Spare part-nr. 48360000)
- 9: Socket Spanner (Spare part-nr. 49059000)*
- 10: Service stops (Spare part-nr. 1405300M)*
- 11: Universal extension set single-lever mixers, 25 mm (Spare part-nr. 14048000)*

* Optional accessories