

29 144 000 SMARTCONTROL CONCEALED MIXER WITH ONE VALVE

PRODUCT DESCRIPTION

- final installation for
- GROHE Rapido SmartBox (35 604)
- GROHE FastFixation metal wall escutcheon, retroactively 6° adjustable
- GROHE Long-Life finish
- GROHE SmartControl push for ON-OFF, turn for volume adjustment from GROHE Water Saving to Full Flow
- exchangeable symbols
- cartridge for temperature mixing
- outlet B = 27 l/min, outlet C = 27 l/min

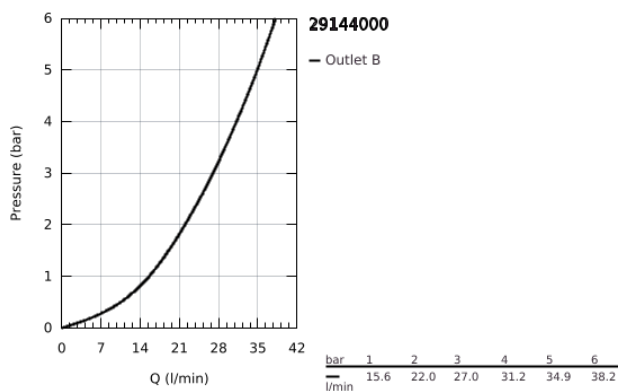
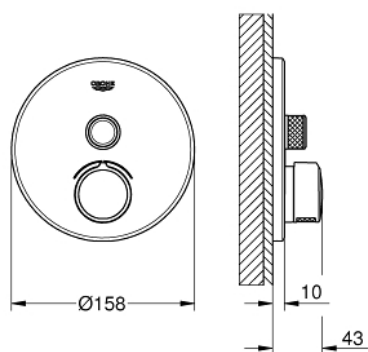

29 144 000 SMARTCONTROL CONCEALED MIXER WITH ONE VALVE

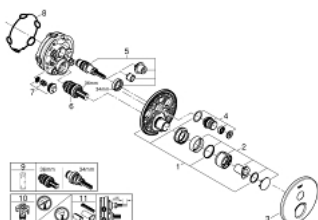

SPARE PARTS

- 1: Mounting plate (Spare part-nr. 48362000)
 - 2: Handle (Spare part-nr. 46990000)
 - 3: Escutcheon (Spare part-nr. 46991000)
 - 4: Push button (Spare part-nr. 48361000)
 - 5: Cartridge (Spare part-nr. 48359000)
 - 5.1: Spindle (Spare part-nr. 49088000)
 - 6: Cartridge (Spare part-nr. 46989000)
 - 7: Non-return valve (Spare part-nr. 49085000)
 - 8: Seal (Spare part-nr. 48360000)
 - 9: Cartridge (Spare part-nr. 48359000)*
 - 10: Service stops (Spare part-nr. 1405300M)*
 - 11: Universal extension set single-lever mixers, 25 mm (Spare part-nr. 14048000)*
- * Optional accessories