

29 120 000 GROHTHERM SMARTCONTROL SAFETY MIXER FOR CONCEALED INSTALLATION WITH 2 VALVES AND INTEGRATED SHOWER HOLDER

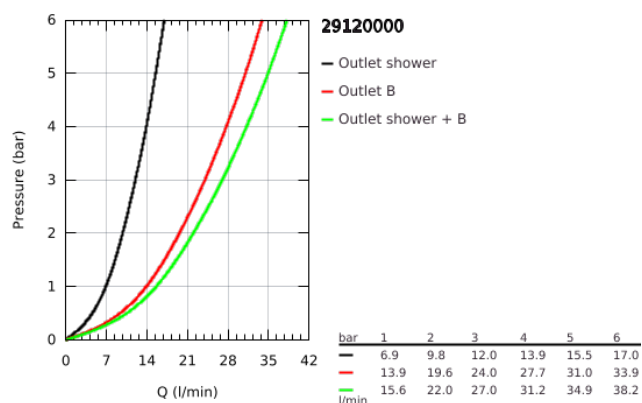
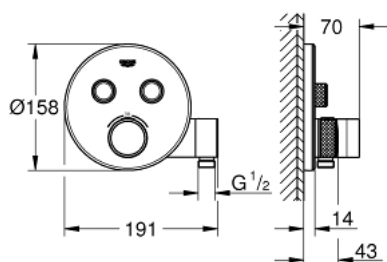

PRODUCT DESCRIPTION

- final installation for
 - GROHE Rapido SmartBox (35 604)
 - GROHE FastFixation metal wall escutcheon, retroactively 6° adjustable
 - GROHE Long-Life finish
 - GROHE SmartControl push for ON-OFF, turn for volume adjustment from GROHE Water Saving to Full Flow
 - exchangeable symbols
 - GROHE TurboStat compact cartridge
- GROHE ProGrip with knurl structure
- GROHE SafeStop safety button at 38°C
- GROHE SafeStop Plus optional temperature limiter at 43°C or 46°C included
- built-in non-return valves and dirt strainers
- multiple outlets can be run simultaneously
- integrated shower union with shower outlet ½"
- flow performance: outlet B = 24 l/min, hand shower = 12 l/min, outlet B + hand shower = 27 l/min

29 120 000 GROHTHERM SMARTCONTROL SAFETY MIXER FOR CONCEALED INSTALLATION WITH 2 VALVES AND INTEGRATED SHOWER HOLDER

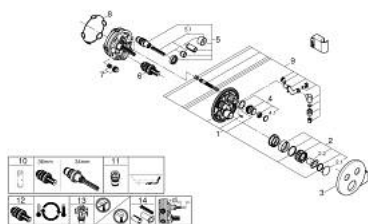

SPARE PARTS

- 1: Mounting Template (Spare part-nr. 48364000)
- 2: Temperature control handle (Spare part-nr. 49029000)
- 2.1: Cover cap (Spare part-nr. 1015030000)
- 2.2: handle adaptor (Spare part-nr. 1015059990)
- 3: Escutcheon (Spare part-nr. 49034000)
- 4: Push button (Spare part-nr. 48361000)
- 4.1: pushbutton (Spare part-nr. 14077000)
- 5: Cartridge (Spare part-nr. 48359000)
- 5.1: Spindle (Spare part-nr. 49088000)
- 6: Thermostatic compact cartridge 3/4" (Spare part-nr. 49028000)
- 7: Non-return valves (Spare part-nr. 47979000)
- 8: Seal (Spare part-nr. 48360000)
- 9: Race (Spare part-nr. 1015049990)
- 10: Socket Spanner (Spare part-nr. 49059000)*
- 11: Backflow protection combination (Spare part-nr. 14055000)*
- 12: GROHE TurboStat cartridge 3/4" (Spare part-nr. 49003000)*
- 13: Service stops (Spare part-nr. 1405300M)*
- 14: Universal extension set single-lever mixers, 25 mm (Spare part-nr. 14048000)*

* Optional accessories