

27 473 002 EUPHORIA SYSTEM 260 SHOWER SYSTEM WITH SINGLE LEVER MIXER FOR WALL MOUNTING

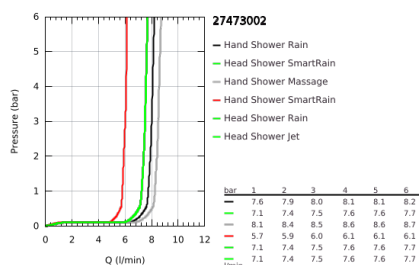

PRODUCT DESCRIPTION (1/2)

- consisting of:
- horizontal swivable 450 mm shower arm
- exposed single-lever shower mixer with diverter
- allows change between:
- head shower Euphoria 260 (26 457)
- 3 spray patterns:
- Rain, SmartRain, Jet
- with ball joint
- rotation angle $\pm 15^\circ$
- hand shower Euphoria 110 Massage (27 239)

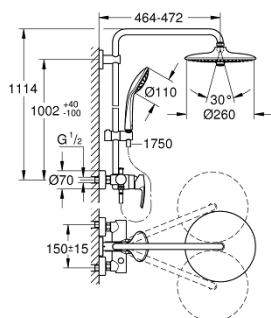

- 3 spray patterns:
- Rain, Massage, SmartRain
- maximum flow rate (at 3 bar): 8.5 l/min
- adjustable in height with gliding element
- Silverflex shower hose 1750 mm 1/2" x 1/2" (28 388)
- GROHE SilkMove 46 mm ceramic cartridge
- GROHE DreamSpray perfect spray pattern

27 473 002 EUPHORIA SYSTEM 260 SHOWER SYSTEM WITH SINGLE LEVER MIXER FOR WALL MOUNTING

PRODUCT DESCRIPTION (2/2)

- GROHE Long-Life finish
- GROHE Water Saving - Less water, perfect flow
- GROHE SprayDimmer (Stepless flow rate reduction)
- GROHE FastFixation upper bracket adjustable
- Inner WaterGuide for a longer life
- SpeedClean anti-lime system
- TwistStop to prevent hose from twisting
- suitable for instantaneous heaters from 18 kW/h
- minimum flow rate 5 l/min.
- minimum pressure 1.0 bar
- professional edition

27 473 002 EUPHORIA SYSTEM 260 SHOWER SYSTEM WITH SINGLE LEVER MIXER FOR WALL MOUNTING

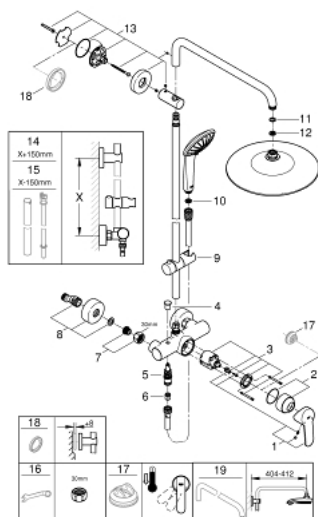

SPARE PARTS

- 1: Lever (Spare part-nr. 46726000)
- 2: Cap (Spare part-nr. 46025000)
- 3: Cartridge (Spare part-nr. 46048000)
- 4: Diverter knob (Spare part-nr. 65648000)
- 5: Diverter (Spare part-nr. 65655000)
- 6: Non-return valve (Spare part-nr. 08565000)
- 7: Screw connection 1/2" (Spare part-nr. 45044000)
- 8: S-union (Spare part-nr. 12662000)
- 9: Glider (Spare part-nr. 12140000)
- 10: Dirt strainer (Spare part-nr. 0700200M)
- 11: Fibre seal dia. Ø18.5 x Ø12 x 2 (Spare part-nr. 0138900M)
- 12: Dirt strainer (Spare part-nr. 48007000)
- 13: Shower bar holder (Spare part-nr. 48279000)
- 14: Shower system pipe for retrofitting (Spare part-nr. 48514000)*
- 15: Shower system pipe for retrofitting (Spare part-nr. 48515000)*
- 16: Special spanner (Spare part-nr. 19377000)*
- 17: Temperature limiter (Spare part-nr. 46375000)*
- 18: Compensation disc (Spare part-nr. 27180000)*
- 19: Shower arm for shower systems (Spare part-nr. 14047000)*

* Optional accessories