

20 190 000 ALLURE THREE-HOLE BASIN MIXER 1/2" S-SIZE

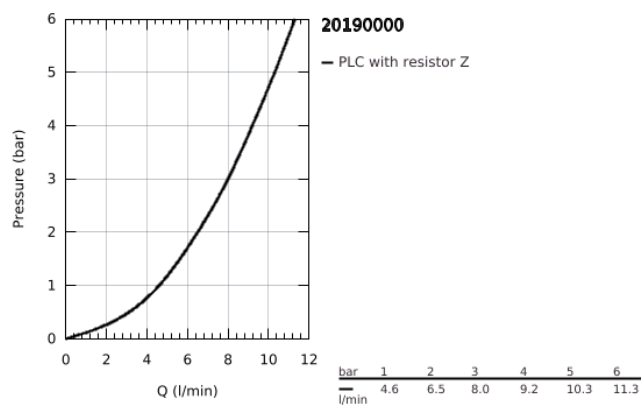

PRODUCT DESCRIPTION

- wall mounted
- without concealed body
- final installation for
 - 32 706 000
 - valves hot/cold with Carbidur ceramic headparts 1/2" - 180°
 - GROHE Long-Life finish
 - flow limiter 8 l/min.
 - spout with mousseur
 - centre distance 200 mm
 - projection 172 mm

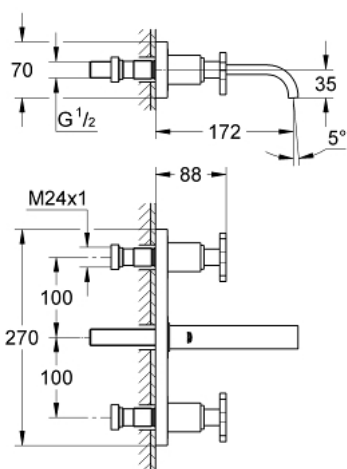

20 190 000 **ALLURE THREE-HOLE BASIN MIXER 1/2" S-SIZE**

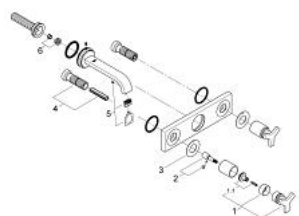

SPARE PARTS

- 1: Handle (Spare part-nr. 46611000)
- 1.1: Replacement handle connection kit (Spare part-nr. 45605000)
- 2: Extension for spindle (Spare part-nr. 45607000)
- 3: Sealing washer (Spare part-nr. 48046000)
- 4: Extension-set, 80 mm (Spare part-nr. 45202000)
- 5: Mousseur (Spare part-nr. 13220000)
- 6: Flow limiter
- 5,7 l/min. at 3.5 bar (GROHE Ecojoy) (Spare part-nr. 46324000)