

19 342 000 **VERIS TWO-HOLE BASIN MIXER**
S-SIZE

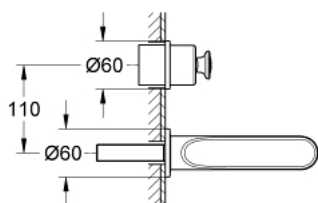
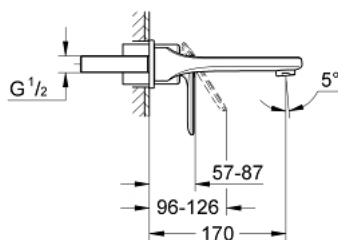

PRODUCT DESCRIPTION

- wall mounted
- final installation for
 - 32 635 000
 - without concealed body
 - separate escutcheons
 - GROHE Long-Life finish
 - SpeedClean mousseur
 - centre distance 110 mm
 - projection 170 mm

19 342 000 **VERIS TWO-HOLE BASIN MIXER**
S-SIZE

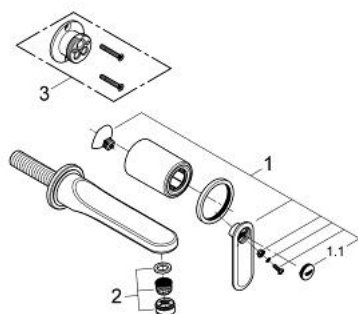

SPARE PARTS

1: Lever (Spare part-nr. 46667000)

1.1: Cover cap (Spare part-nr. 46672000)

2: Flow straightener (Spare part-nr. 64447000)

3: Extension (Spare part-nr. 46627000)*

* Optional accessories