

10 216 7KF 00 GROHTHERM SMARTCONTROL SAFETY MIXER FOR CONCEALED INSTALLATION WITH 3 VALVES

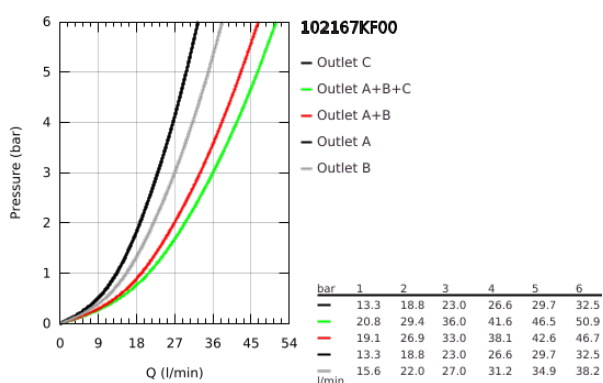
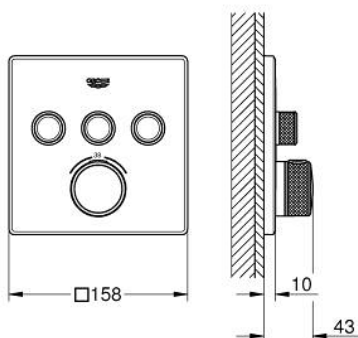

PRODUCT DESCRIPTION

- final installation for
- GROHE Rapido SmartBox (35 604)
- GROHE FastFixation metal wall escutcheon, retroactively 6° adjustable
- GROHE SmartControl push for ON-OFF, turn for volume adjustment from GROHE Water Saving to Full Flow
- exchangeable symbols
- GROHE TurboStat compact cartridge
- GROHE ProGrip with knurl structure
- GROHE SafeStop safety button at 38°C
- GROHE SafeStop Plus optional temperature limiter at 43°C or 46°C included
- built-in non-return valves and dirt strainers
- multiple outlets can be run simultaneously
- flow performance: outlet A = 23 l/min, outlet B = 27 l/min, outlet C = 23 l/min, outlet A + B = 33 l/min, outlet A + B + C = 36 l/min

10 216 7KF 00 GROHTHERM SMARTCONTROL SAFETY MIXER FOR CONCEALED INSTALLATION WITH 3 VALVES

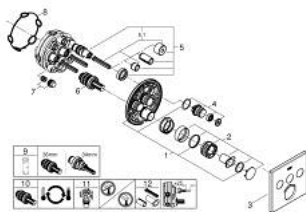

SPARE PARTS

- 1: Mounting plate (Spare part-nr. 48362000)
- 2: Temperature control handle (Spare part-nr. 49029KF0)
- 2.1: Cover cap (Spare part-nr. 101503KF00)
- 2.2: handle adaptor (Spare part-nr. 1015059990)
- 3: Escutcheon (Spare part-nr. 49042KF0)
- 4: Push button (Spare part-nr. 48361KF0)
- 4.1: pushbutton (Spare part-nr. 140772430)
- 5: Cartridge (Spare part-nr. 48359000)
- 5.1: Spindle (Spare part-nr. 49088000)
- 6: Thermostatic compact cartridge 3/4" (Spare part-nr. 49028000)
- 7: Non-return valves (Spare part-nr. 47979000)
- 8: Seal (Spare part-nr. 48360000)
- 9: Socket Spanner (Spare part-nr. 49059000)*
- 10: GROHE TurboStat cartridge 3/4" (Spare part-nr. 49003000)*
- 11: Service stops (Spare part-nr. 1405300M)*
- 12: Universal extension set single-lever mixers, 25 mm (Spare part-nr. 14048000)*

* Optional accessories